

# NGF-122-H

## GLASS DOOR MERCHANDISER WITH CANOPY

Ideal for convenience stores, front-of-house, grocery stores, restaurants and cafés

# NEW AIR



### FEATURES

Self-closing doors with stay-open feature

LED lighting & backlit canopy display

Carel™ digital controller & LED display

Triple-pane tempered glass

Black exterior

Casters & rear stoppers

More efficient motor & condenser

Adjustable shelving



NEMA 5-15P



Intertek

### SPECIFICATIONS

Capacity (Cu. ft)	43.26
Capacity (Liters)	1225 L
Exterior Dimensions (in)	54 1/8" x 32 7/8" x 78 5/8"
Interior Dimensions (in)	49 1/2" x 25 1/2" x 48"
Net Weight (kg/lbs)	200 / 441
Nbr of Shelves	8
Shelf Dimensions	25" x 25"
Nbr of Door(s)	2, hinged
Temperature Range (°C)	-18 TO -22°C
Ambiant Temperature	≤ 25°C
Ambiant Humidity	≤ 55%
Refrigerant (CFC-Free)	R290
Amperage (A)	12.5 A
Voltage (V)	110V / 60Hz
Plug Type	NEMA 5-20P

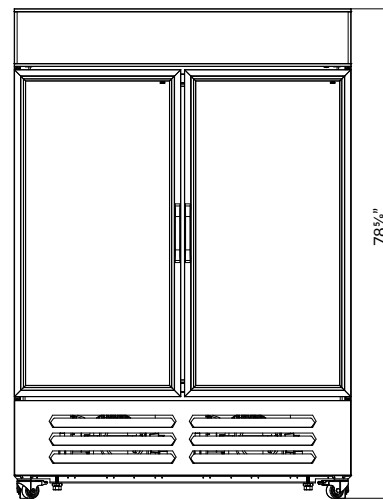

**COMES WITH TWO (2) COMPRESSORS FOR MORE EFFICIENT COOLING**

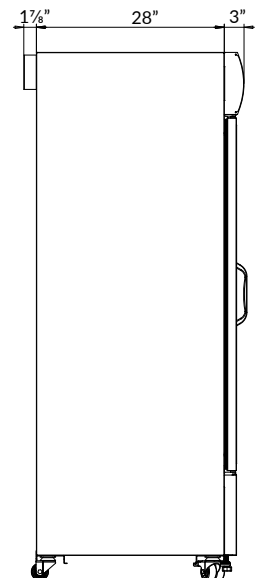
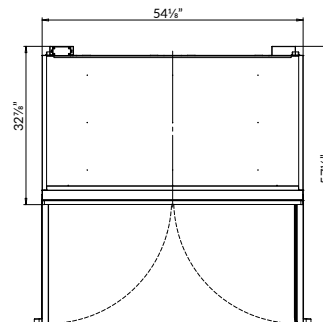

# NEW AIR

\*Design and specifications may change without prior notice for product improvement

CUSTOMER SUPPORT



1-800-567-3620

NEWAIRREFRIGERATION.CA

