

RVO  
**NDDC-48-GC**  
**REFRIGERATED**  
**GRAVITY COIL DELI CASE**

Ideal for convenience stores, front of house, grocery stores & cafés



## FEATURES



Black exterior, stainless steel interior



Digital controller & LED display

LED on top & under each shelf

Gravity coil refrigeration

Adjustable glass shelves



Rear sliding glass doors

GRAVITY COIL systems boast a refrigeration coil at the top of the cabinet that allows cool air to drop down over food, reducing airflow within the case.

## SPECIFICATIONS

Capacity (Cu. ft)	22.5 + 4.6
Capacity (Liters)	638 + 130
Exterior Dimensions (in)	48 1/4" x 33 5/8" x 55 3/8"
Package Dimensions (in)	50 1/2" x 36" x 61 1/2"
Net Weight (kg/lbs)	151 kg / 333 lbs
Door(s)	Sliding, at the back
Temp. Range (main cabinet)	0 TO 4°C
Temp. Range (bottom chamber)	2 TO 12°C
Ambiant Temperature	≤ 30°C
Ambiant Humidity	≤ 55%
Refrigerant (CFC-Free)	R290
Amperage (A)	4.18A
Voltage (V)	110V/60Hz
Power (W)	460
Plug Type	NEMA 5-15P

These types of display cases are best for raw meat, cheese, seafood, salads, & other deli products where avoiding the drying effect of constant air circulation is important.

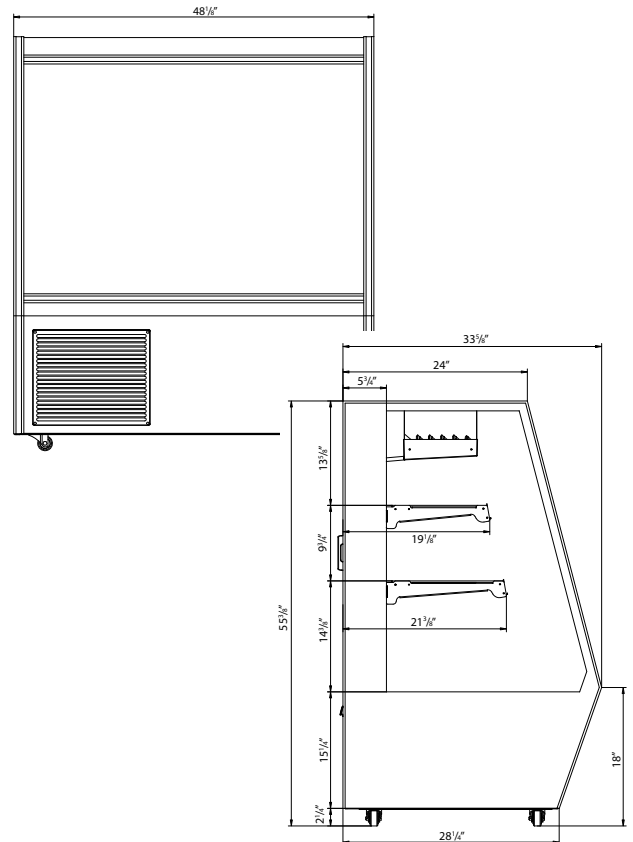

\*Design and specifications may change without prior notice for product improvement

CUSTOMER SUPPORT



1-800-567-3620



NEWAIRREFRIGERATION.CA

