

Energy Efficient Open Air Refrigerator Merchandiser with Side Glass



Also available with 30" depth



Energy Efficiency
Certified



R290 Natural
Refrigerant

| | |
|--|---------------|
| Style | High Capacity |
| Cabinet Color (exterior / interior) | Black/White |
| Gross Capacity (cu.ft. / liters) | 22.13 / 626 |
| Total Display Area (sq.ft. / sq.m.) | 17.82 / 1.655 |
| Cabinet Temperature Range* °F | 32 to 41 |
| Cabinet Temperature Range* °C | 0 to 5.0 |
| Height (inches / cm) | 78.75 / 200 |
| Width (inches / cm) | 47.8 / 122 |
| Depth less translight display (in. / cm) | 22.5 / 572 |
| Interior LED Light Strips | 6 |
| LED Translight Display | 46.2" x 6.65" |
| Adjustable Shelves | 4 |
| Bottom Deck | 1 |
| Casters | Yes |
| Volts / Hz / Phase | 115 / 60 / 1 |
| Amps (Refrigeration System / Heated Evaporation Pan) | 16.0 |
| H.P. (kW) | 1/2 (0.37)x2 |
| Refrigerant | R290 |
| Net Weight (lbs) | tbd |
| Net Weight (kg) | tbd |
| NEMA Configuration | 5-20P |

Great features. Outstanding value.



Brilliant, energy efficient LED lighting creates an impressive visual impact. A unique design that illuminates both merchandise and pricing tags. Standard on all models.



LED backlit display panel provides branding opportunities to promote and increase sales potential.



Medium temperature system factory setting for best preservation of food products. A preferred temperature can be factory set to suit your product storage needs.

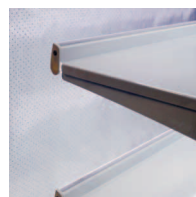

Reflective night curtain helps keep the cold in and saves energy.

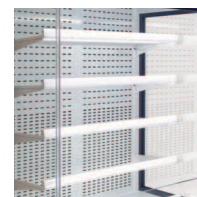

Energy free, Low-E coated side glass panels for added insulation value.



Programmable Electronic Control Center provides real-time information with audible and visual alarms. Standard on all models.

ENERGY EFFICIENT PERFORMANCE

- Eco-friendly, efficient, self contained R290 refrigeration system delivers cabinet temperature range from 32°F to 41°F or, up to 45°F depending on requirements.
- Frost free, forced air system for quick, even cooling with temperature sensed defrost cycles.
- External front mounted electronic microprocessor controller for precise, efficient temperature management. Features continuous digital temperature display, adjustable temperature setpoint, audible and visual temperature alarm.
- Bottom mount condensing unit provides elevated merchandising visibility, keeping products within easy reach.
- High efficiency fan motors reduce energy consumption and maintain optimum air circulation for consistent cabinet temperature.

DURABLE CABINET CONSTRUCTION

- Tough, exterior finish provides long lasting durability to help keep the product looking like new, even after years of service.
- 2" thick walls with high density, foamed in place closed cell insulation for temperature and energy efficiency.
- Bright white galvanized interior walls with baked on finish for a clean look that supports product illumination and provides the perfect back-drop.
- Smooth interior corners for easy cleaning.
- Low profile casters and front levelling legs for easy installation.

CLEAR VIEW SIDE GLASS

- Energy free, Low-E coated, insulated safety glass side panels to help keep the cold inside.

BRILLIANT CABINET LIGHTING

- Cabinet interior features five (5) high intensity, energy efficient white LED shelf lights to showcase merchandise and pricing tags.
- Additional LED strip illuminates merchandise on the top shelf.
- Captivating backlit translight display features a full LED panel for uniform illumination.

STURDY CABINET SHELVING

- Four (4) coated adjustable shelves resist rust and can be adjusted in 1" increments.
- Coated bottom deck.

ELECTRICAL REQUIREMENTS

- Dedicated 20 amp grounded 115V 60Hz single phase circuit with NEMA 5-20R receptacle.



WARRANTY & CUSTOMER CARE

- One (1) year parts and labor. Additional four (4) years on compressor.
- 24/7 Customer Care support and a network of certified licensed technicians to respond to any refrigeration issue.

PRODUCT DIMENSIONS

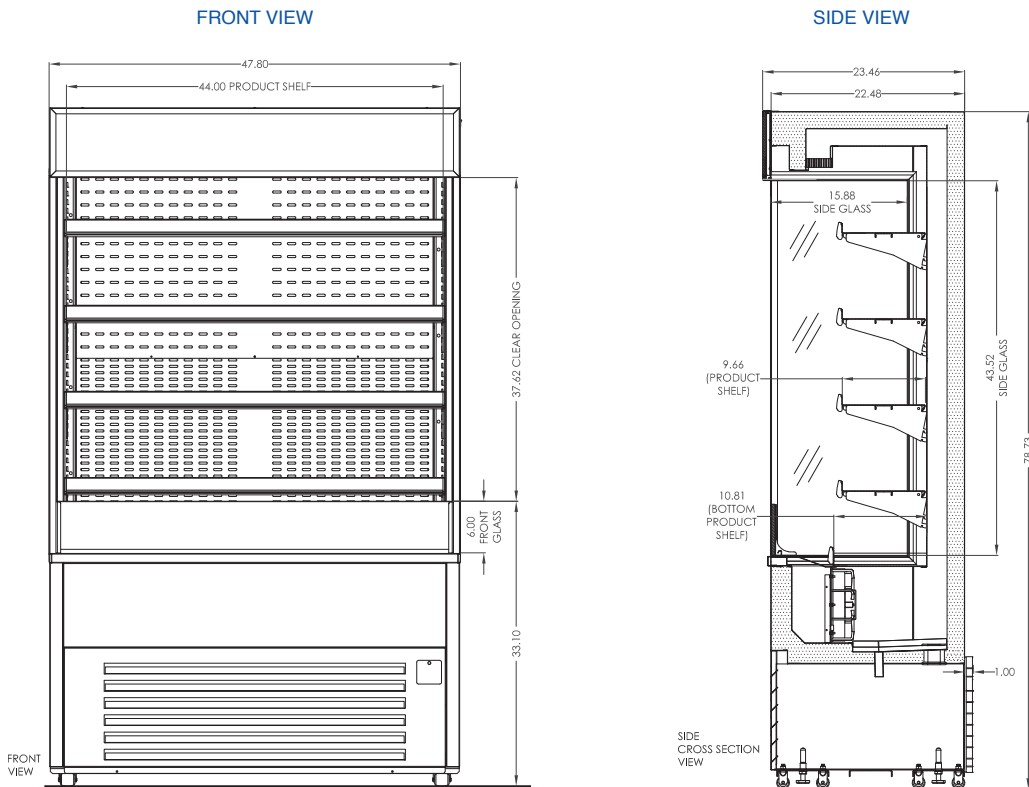

*Cabinet temperature / set temperature can be adjusted as desired through the electronic controller. Designed to operate in an environment of 70°F to 75°F temperature, 55% max relative humidity. Cooler runs most efficiently when fully loaded with products and with 1"-2" air space beneath each shelf. Cooler should not be installed near air vents, fans, doorways or other sources that can disrupt the cooler's air curtain, nor in direct sunlight or close to heat. Regular condenser cleaning and maintenance is required. Cleaning frequency will depend on the installation environment. Warranty is a limited warranty. Please refer to detailed warranty outline available from our Customer Care Department. Specifications subject to change without notice. Weights and dimensions do not include packaging or shipping materials.

Minus Forty Technologies, 30 Armstrong Ave. Georgetown, Ontario Canada L7G 4R9

TEL 800.800.5706 • 905.702.1441 • FAX 905.702.1442 • DUENORTH.com

© Minus Forty Technologies. All Rights Reserved. Minus Forty® is a registered trademark of Minus Forty Technologies.



Energy Standards:
U.S. Department of Energy (DOE)
California Energy Commission.
Natural Resources Canada (Nrcan)