

Energy efficient, eco-friendly hydrocarbon refrigerant with low charge, spark-free components, providing the greatest reliability. Designed with detailed quality to meet all food safety requirements of the foodservice industry.



KEY FEATURES



Electronic Temperature Control

Ensures optimal equipment performance by maintaining products at the ideal temperature for consumption.



Eco-Friendly Refrigerant

Environmentally friendly hydrocarbon refrigerant has low Global Warming Potential (GWP). Meets all USA refrigerant and energy standards.



Electronic Fan Motors

These motors provide improved performance by using only a fraction of the energy required by shaded pole motors.



LED Lighting

Our patented LED system uses a fraction of the energy and has over ten times the lifespan compared to a fluorescent light bulb.



Stainless Steel Material

High-quality material for food preservation, complying with safety and hygiene standards.

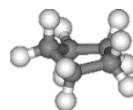

Cyclopentane Insulating Foam

It is eco-friendly as it does not contain Chlorofluorocarbons (CFC) or Hydrofluorocarbons (HFC) and is a highly efficient insulator.

TECHNICAL SPECIFICATIONS

Exterior Dimensions		Interior Dimensions		Usable Interior Capacity	
H: 83 1/8"	211 cm	H: 61 3/8"	156 cm	H: 54 3/4"	139 cm
W: 52 3/4"	134 cm	W: 48 1/8"	122 cm	W: 47 1/4"	120 cm
D: 35 3/8"	90 cm	D: 27 1/8"	69 cm	D: 25 1/4"	64 cm
Usable Volume		49 ft ³	1387.5 lts		
Doors		2			
Door construction		Solid Stainless			
Shelves		6			
Shelves Size		22 3/4"	57.7 cm		
		24 5/8"	62.5 cm		
External Material		Stainless Steel			
Internal Material		Stainless Steel			

REFRIGERATION PERFORMANCE DATA

Refrigerant	R290 4.9 Oz (0.140 kg)	
Energy Consumption	10.82 kWh/24h	
Compressor Power	1/2 HP	
Condenser	Dynamic	
Thermostat setting default	-0.4°F (-18°C)	-11.2°F (-24°C)

ELECTRICAL DATA

Power supply	115V / 60 Hz	
AMPS	9.4 A	
Cord length	118" (300 cm)	
Lighting	2 module, 72 LED per strip	
Plug type	NEMA 5-15P	
Controller	CIR WIFI	

LOGISTIC DATA

Trailer Loads	53': 27	
Unit weight	Gross	Net
	250.5 kg 552 lb	240.5 kg 530 lb
Dimensions w/packaging	H: 90 1/2"	230 cm
	W: 58 5/8"	149 cm
	D: 36 5/8"	93 cm

*Energy consumption based on ANSI/ASHRAE Standard 72-2005.
 *Dimensions rounded up to the nearest inch or centimeter.
 *Specifications subject to change without notice.
 *H:Height, W:Width, D:Depth
 *Specifications subject to change without notice.

CONTACT INFORMATION
 IMBERA | 1925 Shiloh Road, Building #2 Kennesaw, GA 30144
 P: 678-504-6835

PRODUCT VIEWS

Top view

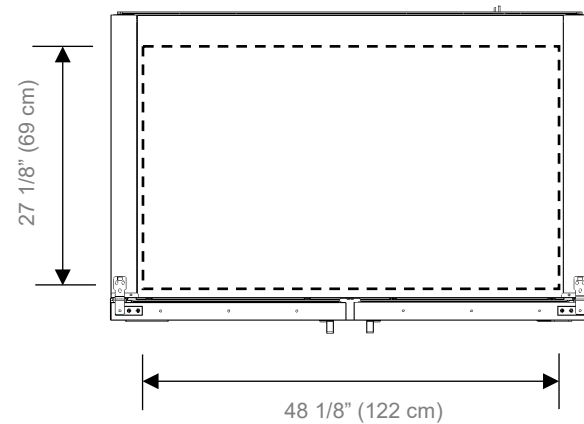

Front view

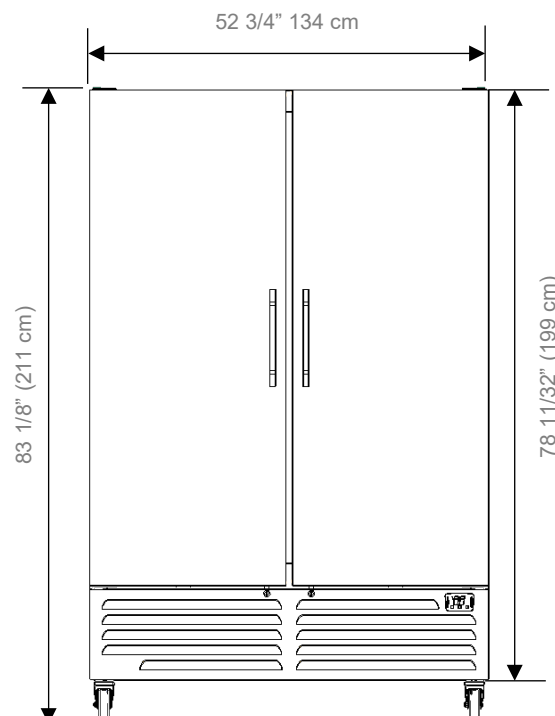

Side view

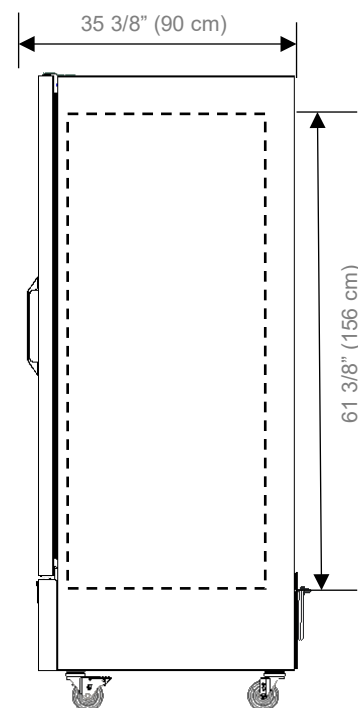

ADDITIONAL FEATURES

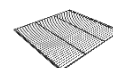

Black epoxy shelves



Mechanical Lock



4\" Pre-installed Casters

Customer Service and warranty

Five-year limited warranty, includes parts and labor.
 An additional two-year warranty is issued on the compressor (USA & Canada only).
 Operators must follow installation and operational guidelines per Imbera User's Manual.
 It is essential that each cooler is directly connected to a single power supply; failure to do so will result in voiding the warranty.
 Customer service: 866.548.5770

24/06/2025