

# FEC120

100% Wood Pellet Smoker



The Fast Eddy's™ by Cookshack FEC120 smoker is a 100% wood pellet smoker with the Cookshack IQ6 electronic control system

The FEC120 features an offset firebox and a convection fan to circulate smoke and heat for steady temperatures throughout the unit. It is the perfect choice for operations who cook moderate amounts of smoked foods or barbecue.

## How it Works

- Heat and smoke are supplied by 100% wood pellets
- Offset firebox and convection fan circulates smoke and heat for even temperatures
- Drippings exit the bottom of the smoker into a removable drip pan for a clean, safe operation

## IQ6 Controller

- Digital Controller
- Wifi & Bluetooth
- Includes 8 programmable, customizable cooking presets
- Alarm cycle
- LCD Display
- USB port for downloading up to 512 hours of cook time onto a FAT formatted USB flash drive
- Features 3-stage, 2-stage cooking options
- Optional meat probe allows the user to set the smoker to a desired internal meat temperature and then automatically cycles into rest when the temperature is met

## Efficient

- Tough double-walled stainless steel construction surrounds 850°F Spin-Glas® insulation
- Retains heat and remains cool to the touch on the outside

## Pellets

- Pellets are clean burning, produce very little ash and create low creosote buildup
- Approved by all major cooking competition sanctioning bodies

# FEC120

100% Wood Pellet Smoker

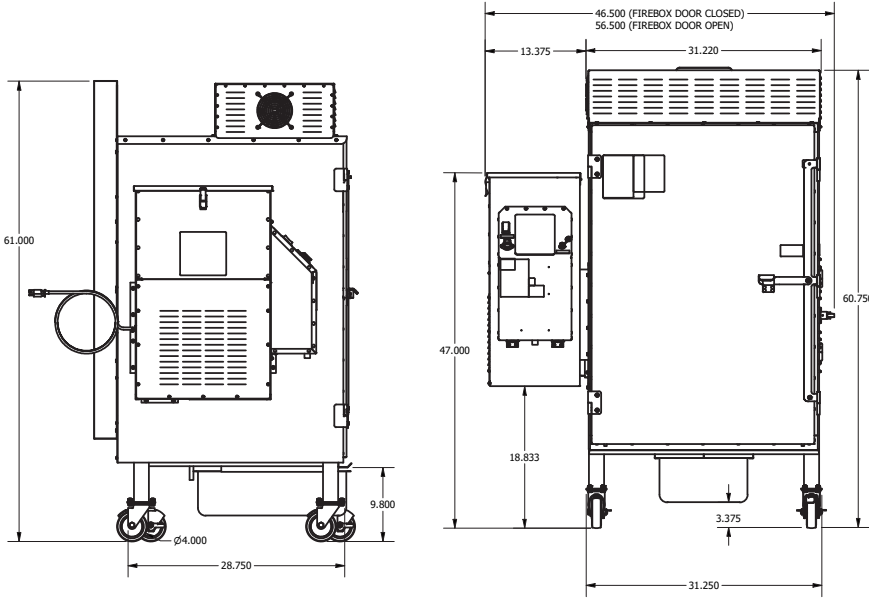

## FEC120 Venting Requirements

Before installation, contact local code officials and a commercial kitchen ventilation contractor to determine codes and permit requirements. Unit must be installed per state and local fire codes and meet NFPA 96 in the US. The unit requires a separate 120 volt, 20 amp circuit and grounded in accordance to the National Electric Code ANSI/NFPA 70-1990 (or comparable codes outside the United States). The Fast Eddy's™ by Cookshack FEC120 and FEC240 must be installed under a commercial hood with fire suppression applicable to local code (NFPA 96). Adequate makeup air is required for safe operation.

<b>Outside Dimensions</b>	46.5"W (54.5"W w/firebox door open) x 61"H x 35"D
<b>Food Capacity</b>	150 lbs. pork butts, 120 lbs. brisket, 90 lbs. ribs, or 30 whole chickens per load
<b>Cooking Area</b>	13.5 sq. ft. (1,955 sq. in.)
<b>Shelves</b>	(5) nickel plated steel 23" x 17" shelves, 4.75" (12.1cm) apart
<b>Approximate Fuel Consumption</b>	1lb. of pellets per hour at 250°F
<b>Approximate Cost of Operation</b>	\$6.21 per 12 hour cycle at average setting (includes pellet and electric cost)
<b>Temperature Range</b>	160°F to 350°F
<b>Electrical</b>	7 amps @ 120 VAC; 36,000 BTU burner, power cord approximate length is 53" (± 6")
<b>Fuel Source</b>	100% Wood Pellets
<b>Pellet Hopper Capacity</b>	35 lbs.
<b>Shipping Weight</b>	535 lbs.
<b>Standard Equipment</b>	5 grills, side racks, drip pan, pre-installed casters, operator's manual, registration card, cookbook, 40 lbs. pellets and Cookshack Spice Kit
<b>Optional Accessories</b>	Meat Probe, Pepper Popper Grills, Jerky Rods, Rib Rack and Stainless Steel Shelves
<b>Warranty</b>	All Cookshack products are backed by a 2 year limited warranty including 90 days full parts and labor.



Cookshack, Inc.  
 2405 Sykes Blvd | Ponca City | OK | 74601-1111 | United States  
 580-765-3669 | 800-423-0698 | Fax: 580-765-2223  
 sales@cookshack.com

Revised February 2025