



223 W Rosecrans Ave., Gardena, CA 90248
T. 310-808-0102 www.blueairfse.com

| | |
|-------------------|--------|
| Project: | |
| Location: | |
| Item #: | |
| Model #: | Qty: |
| AIA #: | SIS #: |
| CSI Section 11400 | |

Back Bar Cooler - Narrow Depth

Model
BLNBB-48B-HC

Model
BLNBB-48B-HC



Cabinet Construction

- Stainless steel top with black powder-coated steel exterior and stainless steel interior
- High-density, foamed-in-place polyurethane insulation – environmentally friendly
- Two (2) adjustable shelves per section
- Interior height allows stacking of three “tall boy” beers
- Four (4) 4” diameter swivel casters with front brakes standard

Refrigeration

- Front-breathing, side-mounted compressor for efficient operation in tight spaces and easy service access
- Forced-air cooling system maintains consistent temperature throughout the cabinet for reliable performance
- Automatic defrost system minimizes maintenance and ensures stable operation

Hydrocarbon refrigerants (R-290)

- Hydrocarbon refrigerant (R-290) increases energy efficiency and does not deplete the ozone layer.

Doors

- Black recessed door handles
- Durable gasket with easy replacement
- Standard door locks

Design & Features

- LED interior lighting for enhanced product visibility
- Digital temperature control with real-time monitoring
- Optimized airflow for consistent cooling performance
- Maintains cabinet temperatures of 34°F to 38°F for optimal beverage preservation



| Model | Doors | Shelves | Capacity (Cu.ft.) | HP | AMPS | W x D x H [†] (inches) | Crated Weight (lbs.) |
|--------------|-------|---------|-------------------|-----|------|--|----------------------|
| BLNBB-48B-HC | 2 | 4 | 12.5 | 1/3 | 3.0 | 49 ¹ / ₈ x 24 ³ / ₈ x 36 ¹ / ₄ | 268 |

Back Bar Cooler - Narrow Depth

PLAN VIEW

(Unit: inches)

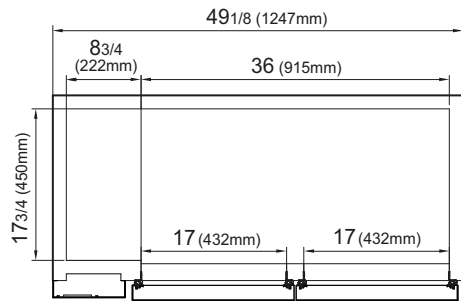

TOP VIEW

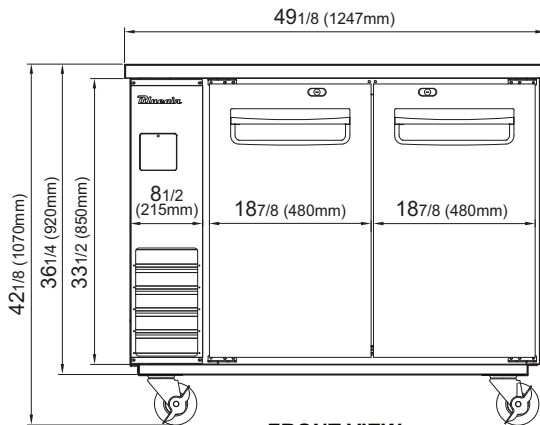

FRONT VIEW

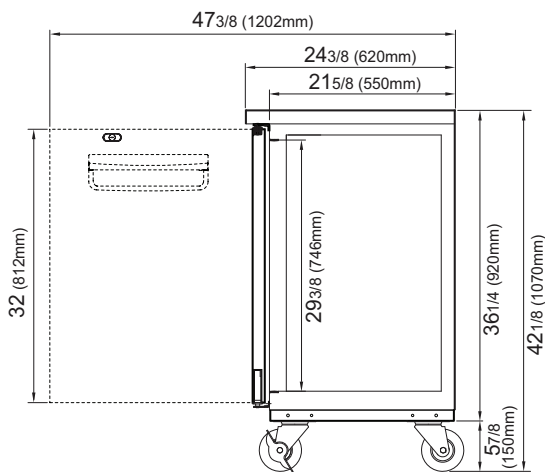

SIDE VIEW

Model

BLNBB-48B-HC

| | |
|---------------------------|--|
| Voltage | 115V/60Hz |
| NEMA Config. |  NEMA 5-15P |
| AMPS | 3.0 |
| HP | 1/3 |
| Cord Length (ft.) | 9.2 |
| Refrigerant | R-290 |
| Ext. Width (inches)(mm) | 49 1/8 (1247mm) |
| Ext. Depth (inches)(mm) | 24 3/8 (620mm) |
| Ext. Height (inches)(mm)† | 36 1/4 (920mm) |
| Doors | 2 |
| Shelves | 4 |
| Net Capacity (cu. ft.) | 12.5 |
| 6-pack of 12 oz Bottles | 36 |
| 6-pack of 12 oz Cans | 72 |
| Net Weight | 231 lbs. (105 kg) |
| Gross Weight | 268 lbs. (122 kg) |

Specifications subject to change without notice.
† Height does not include 5-7/8" for caster height.

Warranty



3 Year Parts and Labor Warranty
5 Year Compressor Warranty

Standard Features

- Four (4) 4" diameter casters with front brakes
- Door locks
- Self-contained system



223 W Rosecrans Ave., Gardena, CA 90248
T. 310-808-0102

 blueairfse.com
 orders@blueairfse.com