

## Fresh Mix Dispenser with 1 or 2 Hoppers



Model FMD-1

### Models FMD-1 & FMD-2

Dimensions: 30"H x 7.9"W x 21"D  
(76.2cm H x 20.1cm W x 53.3cm D)



Model FMD-2



Model FMD-1 available  
with optional  
Hot Chocolate Display

## Features

### Fresh Mix Dispensers

- Space saving narrow 8" (20.3 cm) cabinet width.
- Variable speed hopper motors offer a wide range of product mix ratios (0.75 to 6.6 grams of powder per second).
- Large easy-to-fill translucent hoppers ensure quick and timely refilling.
- FMD-1 = one 8 lbs. (3.6 Kg)
- FMD-2 = two 4 lbs. each (1.8 Kg)
- Lighted graphics merchandise drinks for maximizing profits.
- Large hot water reservoir provides 4.2 gal. (15.9 L)/hour serving capacity.
- Adjustable legs & drip tray allows up to 7" (17.8 cm) opening for 20 oz. cups.
- Specially designed mixing system guarantees perfect beverages every time.
- Improved automatic rinse reduces run-on after beverage is dispensed.
- Designed to be easily serviced from front and top of machine.

## Related Products

**Easy Clear<sup>®</sup> EQHP-10**  
Product No. : 39000.0004

**Easy Clear<sup>®</sup> EQP-10L**  
Product No. : 39000.0001



### Features deluxe whipper chambers:

1. Robust whipper to ensure full flavor yield.
2. Specially designed self cleaning mixing chamber.
3. Exhaust fan to siphon off moisture that can cause powder buildup.
4. Hot water dispense for easy clean-out.
5. Quick disconnecting parts for thorough sanitizing.

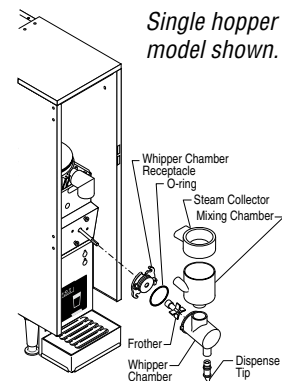

Single hopper  
model shown.

### Model

FMD-1

FMD-2

### Agency Listing



# Dimensions & Specifications



Model	Product #	Volts	Amps	Tank Htr Watts	Total Watts	Brewing Capacity/hr	Cubic ft <sup>3</sup> /m <sup>3</sup>	Weight lbs./kg	Cord Attached
FMD-1 BLK	28700.6001	120	11.7	1320	1400	4.2 gal./15.9**	7.6 / .22	64 / 29	Yes*
FMD-1 BLK	28700.6004	120/240	15.4	3500	3600	8.5 gal./32.2**	7.6 / .22	64 / 29	Yes†
FMD-1 BLK+	28700.6007	120	11.7	1320	1400	4.2 gal./15.9**	7.6 / .22	64 / 29	Yes*
FMD-2 BLK	29200.6001	120	11.7	1320	1400	4.2 gal./15.9**	7.6 / .22	69 / 31	Yes*

\*Power cord (NEMA 5-15P) 15 Amp-120V machine only. † Power cord (NEMA L14-20P) 120/240 V machine only.

\*\*Based on incoming water temperature of 50°F.

+includes Hot Chocolate Display

Mug display standard on all models. Hot chocolate display option available as special order on FMD-1.

Electrical: 120V Model requires 2-wires plus ground service rated 120V, single phase, 60 hz. 120/240V model requires 3-wires plus ground service rated 120/208 or 120/240V, single phase, 60Hz.

Plumbing: 20-90 psi (138-621 kPa) from a 3/8" (10 mm) or larger supply line. A shut-off valve should be installed in the line before the unit. Install a regulator in line when pressure is greater than 90 psi to reduce it to 50 psi. Supplied with 1/4" (6.4 mm) male flare fitting.

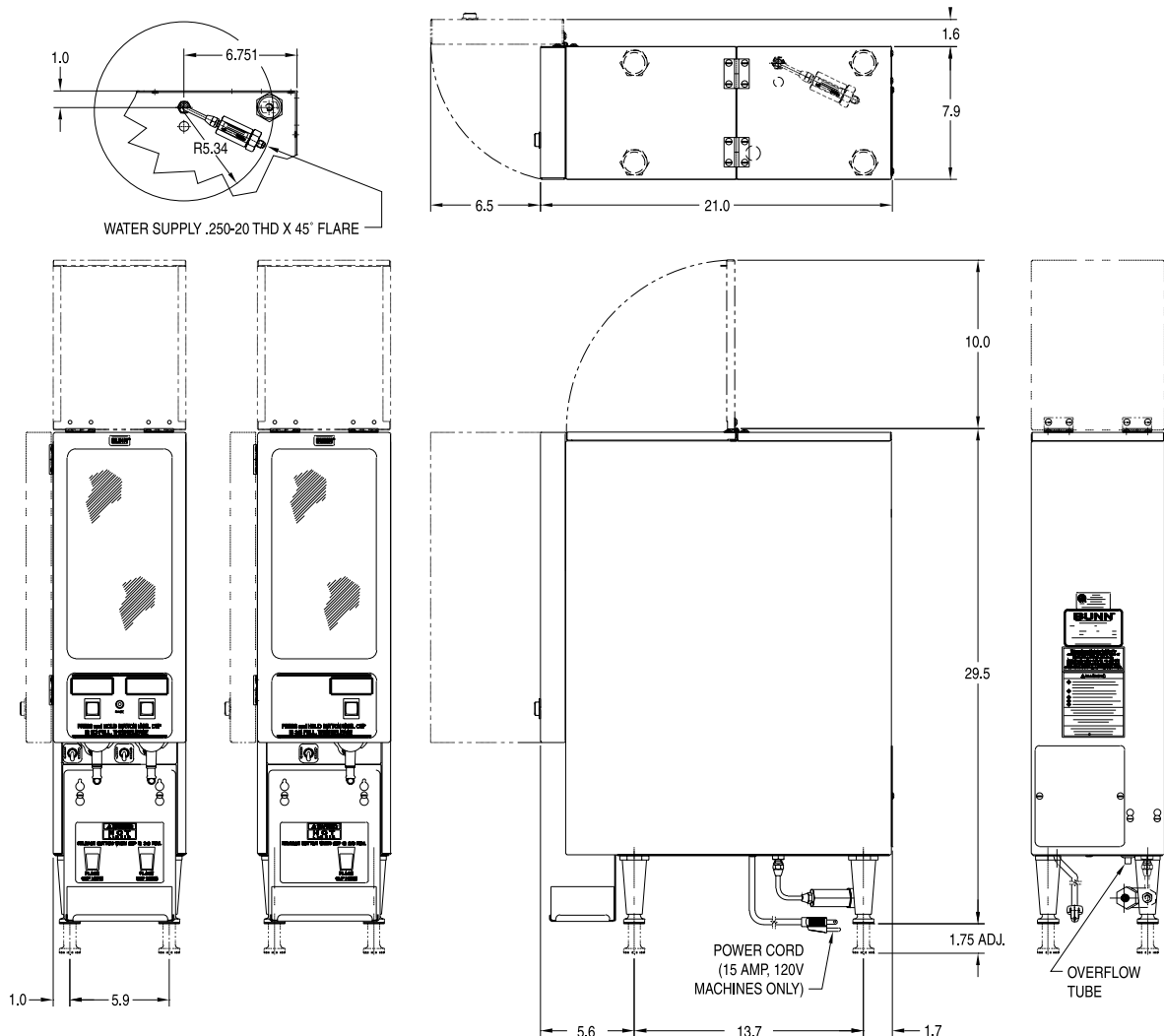

Bunn-O-Matic® Corporation of Canada • 280 Industrial Pkwy South, Aurora Ontario. L4G 3T9 • (905) 841-2866 • www.bunn.com

BUNN® practices continuous product research and improvement. We reserve the right to change specifications and product design without notice. Such revisions do not entitle the buyer to corresponding changes, improvements, additions or replacements for previously purchased equipment.

All dimensions shown in centimeters.